

## Diaphragm Pump 54 Series

### Features & Benefits

Positive displacement Pump  
Can Run Dry  
Demand Pump  
Easy Connecting  
Industry Standard mount pattern

### Typical Applications

Water Treatment/RO  
Agricultural Spraying  
General Industrial  
Automotive  
Alternative Energy/Solar  
Agriculture and RV

### PUMP

**Type**  
5 chamber positive displacement diaphragm pump, self priming, capable of being run dry

#### Mode

Demand & By pass

#### Liquid Temperature

140°F (60°C) Max.

#### Priming Capabilities

6 feet (1.8 m) suction lift

#### Max Pressure

60 PSI (4.2 bar)

### Inlet/Outlet Ports

1/2" MNPT

### Weight

5.51lbs (2.50 kg)

### MOTOR

#### Duty Cycle

Continuous

#### Leads

14 AWG, 9.4" long with  
2-Pin connector/Leads

#### Voltage

12v/24v DC

### Standard Accessories



More details and other optional accessories

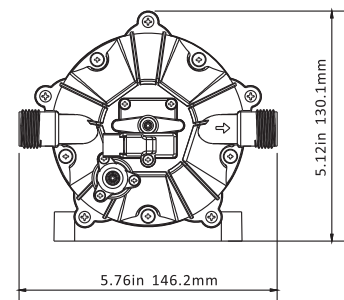
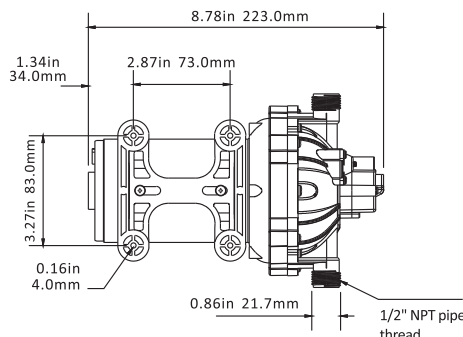

### STANDARD PUMP CONFIGURATIONS

Model	Voltage	Control Type	GPM/LPM	PSI/BAR	Max Draw(A)	Valves	Diaphragm	Ports	Wire Connections
700035222	12V DC	Switch & By pass	5.0/18.9	60/4.2	17.0	EPDM	Santoprene	1/2" MNPT	2-Pin/Leads
700035221	24V DC	Switch & By pass	5.0/18.9	60/4.2	9.0	EPDM	Santoprene	1/2" MNPT	2-Pin/Leads